



GRAND SPORT ULTRA GC400UL

For those looking for a motorhome that appeals to the muscle car lover in all of us, may we introduce the new Grand Sport Ultra GC400UL. Not only does it look better, ride better and haul better than about any other motorhome out there, serviceability, safety and power are equally impressive. A monster Mercedes Benz® MBE 4000 engine and its 450 horses and this Ultra exudes pure muscle. It offers an incredible twenty tons of towing power.

SPECIAL FEATURES

- Granite® countertops
- Travertine® stone tile flooring
- Hardwood cedar-lined wardrobes
- Large flat screen TV & Bose® LS 38 DVD/CD Surroundsound® system
- Freightliner® Columbia chassis
- Granite® countertops
- Travertine® stone tile flooring
- Hardwood cedar-lined wardrobes
- Large flat screen TV & Bose® LS 38 DVD/CD Surroundsound® system
- 450-hp MBE 4000-450 engine



Elegance and flair reside within every inch of the GC400UL. There is also more roominess than ever as it expands to 7

- **Optional 40,000-lb. towing capacity** *by 8 feet wide.*
- **Ultraleather upholstery**
- **One-year free Club Max membership**

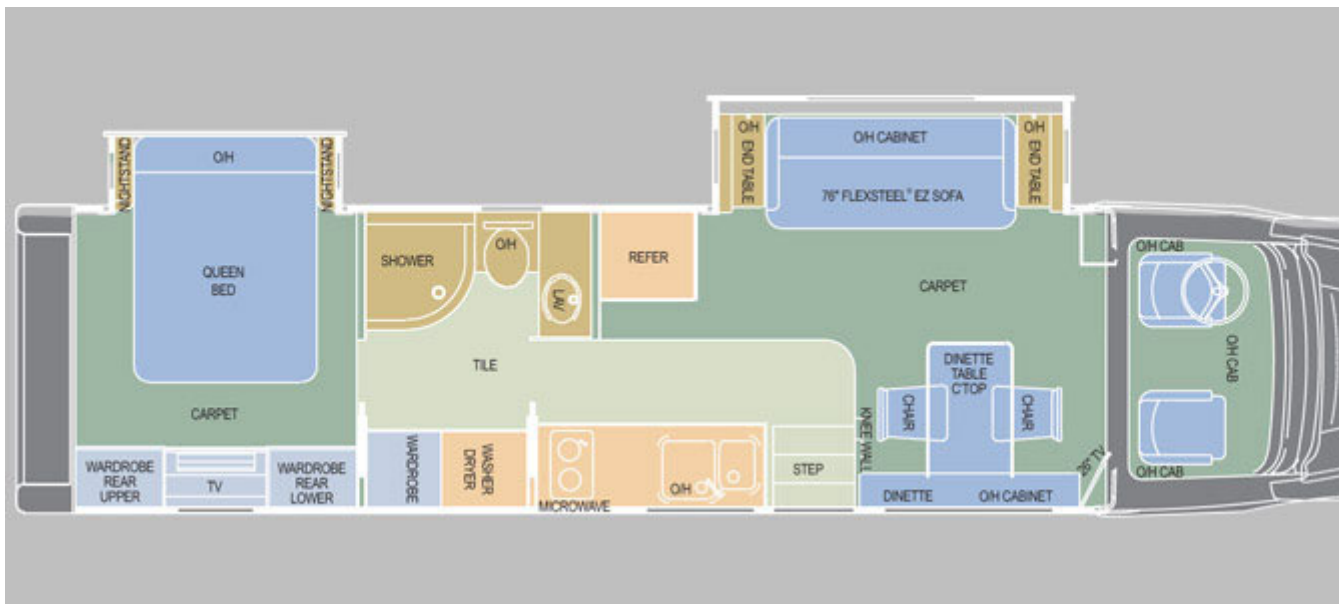

GRAND SPORT ULTRA GC400UL

Great design goes beyond just colors, fabrics and hardwoods. It also extends to designing smart convenient floorplans. Ones that give you more storage space, more convenience and ample room to live your RV life. We applaud our designers because they have done just that.

KEY DIMENSIONS

- Overall length 39' 6"
- Interior width
- Exterior width 8' 6"
- Interior height 7' 0"
- Exterior height 12' 4"
- GVWR 54,000 lb.
- GCWR 80,000 lb.
- Wheelbase 280"
- Fuel capacity 140 gal.
- Water capacity
 - Fresh 110 gal.
 - Grey 52 gal.
 - Black 52 gal.
- LPG capacity (optional - no standard) 48 gal./160 lb.
- Sleeping

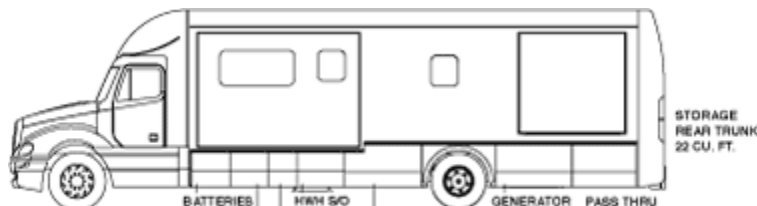
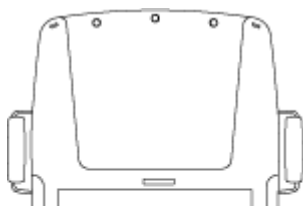
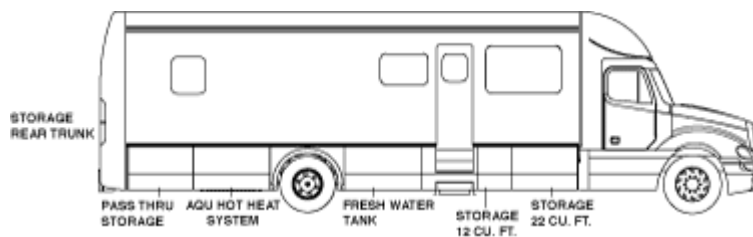



Chassis Features

Engine (Standard): Freightliner® Columbia MBE 4000-450

Horsepower: 450-hp @ 2000 RPM
Torque: 1550 lb./ft. @ 1100 RPM

Transmission: Six-speed Allison® 4000TRV auto push button

Fuel tank: 140 gal.

Brakes: Full air drum (ABS)

Engine brake: Mercedes® off/low/high comp and exhaust

Front axle: 14,000 lb.

Rear axle: 23,000 lb.

Suspension (front): Taperleaf 14,000-lb.

Suspension (rear): Airliner 23,000-lb. (Granning tag 14,360-lb. - GC420UL, GC450UL)

Rear axle ratio: 3.73 (3.90 GC450UL)

Alternator: 270-amp

Chassis batteries: Three Alliance 1131 Group 31 12v maintenance free

Battery disconnect: Below driver seat

Block heater: 1500-watt/115-volt

Aluminum wheels: Standard

Tires: Michelin® XZE 275/80 R22.5 14-ply radial

Auxiliary driving lights

ICC lights

Exterior Features

Paint

- Option 1: Tawny Ridge (tan)
- Option 2: Latte (taupe)
- Option 3: Bay Moon (black & silver)
- Option 4: Bordeaux (burgundy)
- Option 5: Ravenwood (black & gold)

Hydraulic jacks: Four-point fully-automatic leveling jacks

Hitch (Standard): 14,000-lb. capacity
Hitch (Optional): 40,000-lb. capacity

Awning (Standard): Full length Zip Dee® awning curb side

Awning (Optional): Full length Zip Dee® awning road side
Optional window awnings: Built into Zip Dee® slide awnings

Lighted grab handle

External storage: Aluminum doors/steel boxes/lighted Rear trunk

Docking lights: 8

Air service line

Power step at entry door

Exterior gas grill option: (Forces LP system and LP detector)

Optional AC/DC portable refrigerator/freezer

General Interior Features

Interior decors

- Option 1: Tawny Ridge (tan)
- Option 2: Latte (taupe)
- Option 3: Bay Moon (black & silver)
- Option 4: Bordeaux (burgundy)
- Option 5: Ravenwood (black & gold)

Flooring

Living Room/Bedroom: Deluxe sculpted carpet

TV: 26"

Cable-ready

Satellite (Standard): Fully-automatic digital
Satellite (Optional): In-motion

Lighting

Ceiling: Deluxe residential style
Floor: Night lighting throughout

Sound system

Standard: Bose® LS 38 DVD/Surroundsound® System

Ceiling material: Deluxe vinyl padded ceiling

Interior wall material: Deluxe vinyl padded wall

Window

Shades: High style "silhouette" tilt shade
Valence: "Soft Touch" vinyl

Furniture

Sofa (Standard): Flexsteel® EZ bed/sofa
Sofa (Optional): Hide-A-Bed with air mattress

Fantastic fans: Yes w/ rain sensor and remote

Safety features: LPG leak detector, 12-volt carbon monoxide detector, smoke detector, fire extinguisher

Kitchen Features

Countertop: Granite® with backsplash, large double-bowl sink with cover

Faucet: Nickel® single handle faucet with pull-out spray head

Cook top: Amana® electric deluxe, glass top two-burner - black (Forces LP system and LP detector two-burner gas optional)

Microwave: Amana® convection microwave- stainless steel

Refrigerator: Amana® 15 cu. ft. electric double-door residential stainless steel
Optional: Dometic® 10 cu. ft. two-way w/ ice maker

Dinette: Four free-standing chairs (two folding) w/ Granite® table
120-volt outlet & phone jack

Flooring: Travertine® stone tile
Optional: Hardwood

Bathroom Features

Countertop: Granite® lavatory top w/ integrated sink w/ Nickel® accessories

Flooring: Travertine® stone tile
Optional: Hardwood

Medicine cabinet: Deluxe

Shower: One-piece fiberglass shower with skylight

Toilet: Thetford® China

Vent fan: Fantastic® w/ rain sensor

Washer/Dryer (Optional)

Bedroom Features

Sleeping: 74" x 60" RV Queen I.S. mattress, 74" x 48" Flexsteel® EZ bed (74" x 60" Hide-A-Bed with air mattress optional)

Bedroom TV: 26" LCD with high definition satellite receiver

Flooring: Deluxe sculpted carpet

Wardrobes: Hardwood cedar-lined

Bedsprad & Pillows: Designer

Night stands: Hardwood

Passenger seat: Flexsteel® ultraleather B air/swivel pedestal

Power steering, Windows

Cab doors: Power door locks and window

Windshield wipers: Intermittant

Cab radio: AM/FM/CD radio

Cab mirrors: Chrome heated/ remote

Steering wheel: VIP 18" two-spoke satin w leather wrapped

ICC lights

Cruise control

Roof mounted dual air horns

Chassis battery disconnect

Manual air-dump switch

Full front cab sound insulation

CB radio: Standard

Dash-mounted air-restriction indicator

Trailer brake hand control valve

Overhead directional reading lights

Dash instrumentation: Speedometer, engine coolant temp, pyrometer rear axle ammeter, primary/secondary air pressure digital voltmeter, brake application air gauge, transmission oil temp gauge, turbo air pressure tachometer

Rear sonar (Optional)

Tire air pressure monitor (Optional)

Construction Highlights

Floor: Heavy-duty 4" E-coated steel frame rubber isolators

Walls: Sculptured, aerodynamic, fiberglass sidewall panels

Aluminum framed: Square-tube aluminum sidewall w/ all wall penetrations box frame
Windows: Panoramic bonded, tinted

Roof: Square-tube aluminum-framed, one-radiused fiberglass

Insulation

Floor: R-11 solid block foam
Sidewall & Ceiling: R-8 solid block foam

Cab: Steel safety cage surrounding transit to coach

Front transition aerodynamic fiberglass

Molded fiberglass rear body cap

Slide outs: All hydraulic with side cross flow windows

Utilities

Heating - Furnace: 50,000 BTU (12 gal.) / deluxe heating and water system
Single, digital thermostat for heating & cooling
Optional heating systems: 20,000 & 40,000 Btu Suburban LP- gas

Electrical

Coach batteries: Four 4D AGM

Optional: Four 8D AGM

Inverter: 3000 watt

Optional: Dual 3000 watt

Power cord: 50-amp w/ power reel

Generator (Standard): 8.0 KW Powertec

Kitchen/Bath: Travertine® stone tile
Flooring option: Hardwood

Cabinets

Wood

Option 1: Natural Cherry

Option 2: Stained Cherry

Option 3: Natural Maple

Hinges: Deluxe, hidden cabinet hinges

Latches: Posi-Lock

Vent fan: Fantastic® fan w/ temp control and rain sensor

Driver Compartment

Backup camera: Color

Two side rear view cameras: Standard

GPS navigation system

Auxiliary 12-volt in-dash receptacle

Engine air conditioning

Driver seat: Flexsteel® ultraleather Bostrom - air/swivel pedestal

Optional: 12.0 KW Powertech®

Auto generator start

Multi-plex switching system

Coach battery disconnect switch by entr

Cooling: Dual, low profile roof air conditioner BTU with heat pumps

Insulated ceiling air ducts w/ controllable

Plumbing/Water

Water heater: Ten-gal. Suburban® LP - 12-volt hi-capacity water pump: Multi-po switching

Heated water and holding tanks

Fresh water hose & power reel



GRAND SPORT ULTRA GC400UL

The GC400UL reaches a new level of luxury. Superior grades of fabric, silhouette power shades, cu. ft. residential style refrigerator with stainless steel double doors, Granite® countertops and Travertine® tile flooring are features you would find in the finest homes but can now also be found in the GC400UL.



The queen size Comfort Select® Dual Control bed in the large rear bedroom is so comfortable you'll think you're dreaming. You'll also find plenty of storage inside the gorgeous cedar-lined wardrobes.



Luxury features come standard in the GC400UL. They include stylish ultraleather upholstery, plenty of storage, rich hardwood wardrobes with cedar linings, a Bose® 38 DVD/CD Surroundsound® system and top-of-the-line televisions both inside and one outside.



The galley features Granite® countertops and Travertine® stone tile flooring that are not only gorgeous but are strong and durable to last for years on end.



The spacious cockpit features overhead storage, GP navigation system, CB radio and Flexsteel® Bostror ultraleather driver and passenger chairs that adjust your specific comfort with air and swivel pedestals.

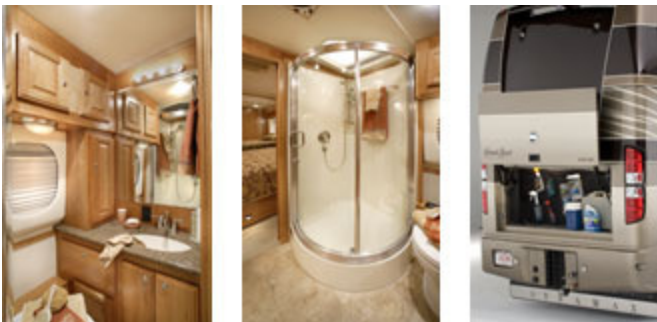

(1 & 2) The roomy bathroom features Travertine® stone tile flooring, a gorgeous Granite® lavatory with Nickel® accessories, a one-piece fiberglass shower with skylight and lots of cabinet space for storage. (3) You'll find a surprisingly large amount of storage. An even bigger surprise is the extra storage available in the rear trunk.

