

The logo for Dynamax Corporation, featuring the word "DYNAMAX" in a large, bold, serif font above the word "CORPORATION" in a smaller, all-caps, sans-serif font. To the right of the text is a stylized globe icon composed of horizontal lines.

DYNAQUEST XL DQ320XL

Couples looking to downsize from the bulky, bus-style motorhomes to something more manageable should check out the DynaQuest DQ320XL. The muscular Cummins® 330-hp engine and rugged Freightliner® chassis literally produce tons of towing power. And with a rear trunk that holds up to 100 cubic feet of gear and lots of extra storage space inside and out, the DQ320XL still has enough space for everything you need.

SPECIAL FEATURES

- Freightliner® M2 Heavy chassis
- 350-hp CAT® 350 engine
- 14,000-lb. towing capacity
- Corian® countertops
- Hardwood flooring
- Ultraleather upholstery
- Hardwood wardrobes
- Large flat screen TV & Bose® LS 18 DVD/CD Surroundsound® system
- One-year free Club Max membership

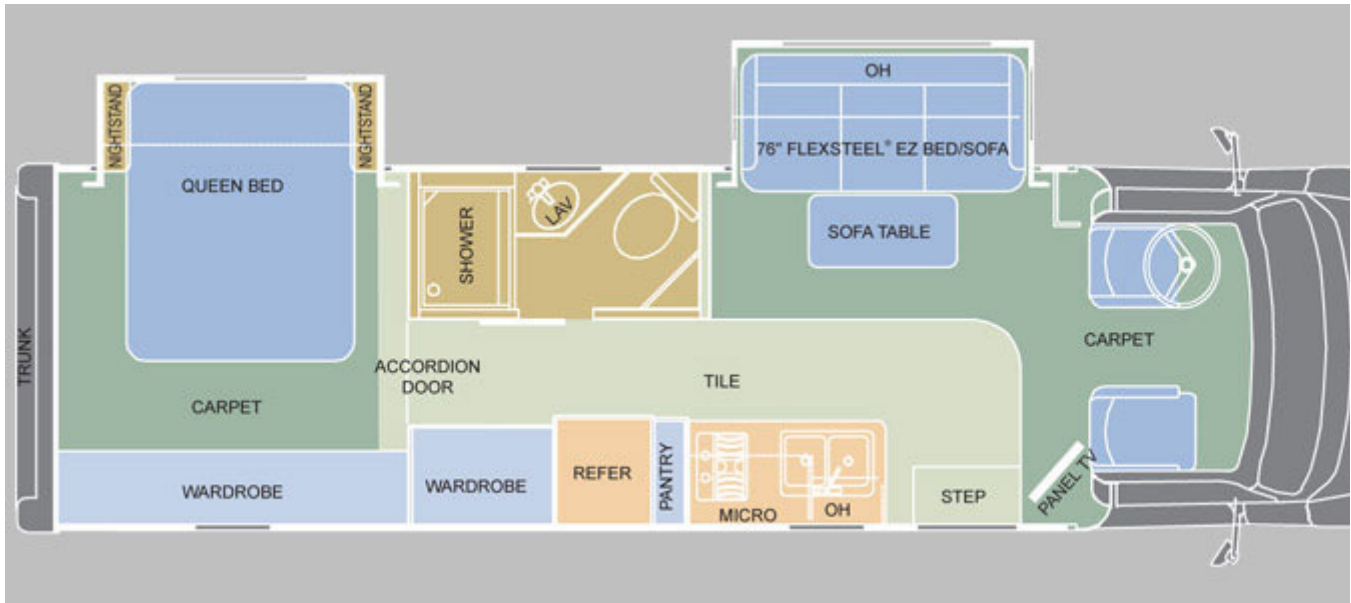

DYNAQUEST XL DQ320XL

Great design is more than just colors, fabrics and exterior styling. It also extends to the floorpla floorplan is designed to be roomy, comfortable and convenient.

KEY DIMENSIONS

Overall length	33' 4"
Interior width	7' 9"
Exterior width	8' 5"
Interior height	6' 6"
Exterior height	11' 8"
GVWR	33,000 lb.
GCWR	44,500 lb.
Wheelbase	226"
Fuel capacity	100 gal.
Water capacity	
Fresh	90 gal.
Grey	44gal.
Black	44 gal.
LPG capacity	20.3 gal./ 68 lb.
Sleeping	

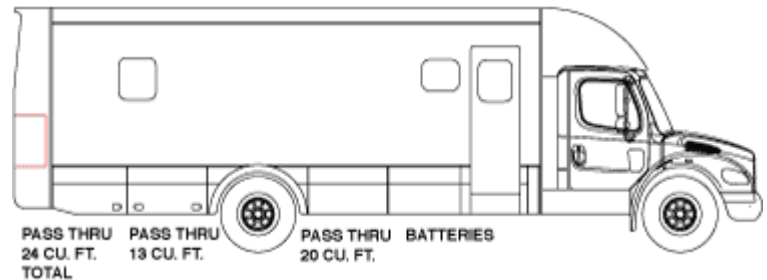



DYNAQUEST XL DQ320XL

Chassis Features

Engine (Standard): Freightliner® M2 Heavy Cummins® 330

Horsepower: 330-hp @ 2200 RPM
Torque: 1000 lb./ft @ 1440 RPM

Transmission: Six-speed Allison® 3200

Fuel tank: 100 gal.

Brakes: Air drum (ABS)
Engine brake: PAC exhaust

Front axle: 12,000

Rear axle: 21,000

Suspension (front): Taperleaf 12,000-lb.

Suspension (rear): Airliner 21,000-lb.

Rear axle ratio: 4.88

Alternator: 270-amp

Chassis batteries: (2) Alliance 1031 Group 31 12v maintenance free

Battery disconnect: Below driver seat

Block heater: 1000-watt/ 115-volt

Aluminum wheels: Standard

Tires: Michelin® XZE 275/80 R22.5 14-ply radial

Auxiliary driving lights

ICC lights

Exterior Features

Paint

Option 1: Mocha (tan)
Option 2: Briarwood (taupe)
Option 3: Quick Silver (black & silver)
Option 4: Russet Ridge (burgundy)
Option 5: Onyx (black & gold)

Hydraulic jacks: Four-point semi-automatic leveling jacks

Hitch (Standard): 15,000-lb. capacity

Awning (Standard): A&E® box
Awning (Optional): Girard power
Optional window awnings

Lighted grab handle

External storage: Aluminum doors/steel box/lighted
Rear trunk

Docking lights: 6

Air service line

Power step at entry door

Exterior gas grill option

Optional AC/DC portable refrigerator/freezer

General Interior Features

Interior decors

Option 1: Mocha (tan)
Option 2: Briarwood (taupe)
Option 3: Quick Silver (black & silver)
Option 4: Russet Ridge (burgundy)
Option 5: Onyx (black & gold)

Flooring

Living Room/Bedroom: Deluxe sculpted carpet

Latches: Posi-Lock

TV: 23"

Cable-ready

Satellite (Standard): Auto
Satellite (Optional): In-motion

Lighting

Ceiling: Deluxe residential style
Floor: Night lighting throughout

Sound system

Standard: Bose® LS 18 DVD/Surroundsound®
System
Optional: Bose® LS 28 DVD/Surroundsound®
System

Ceiling material: Deluxe vinyl padded ceiling

Interior wall material: Décor wallboard

Window

Shades: Day/night pleated
Valence: "Dyna Style" matched fabric lambrequin

Furniture

Sofa (Standard): Flexsteel® EZ bed/sofa
Sofa (Optional): Hide-A-Bed with air mattress

Fantastic fans: Yes w/ rain sensor

Safety features: LPG leak detector, 12-volt carbon monoxide detector, smoke detector, fire extinguisher

Kitchen Features

Countertop: Corian® large double-bowl sink with cover

Faucet: Single handle faucet with pull-out spray head

Cook top: Gas three-burner

Microwave: Convection microwave

Refrigerator: Dometic® 10 cu. ft. (stainless steel)

Dinette: Sofa Corian® table
120-volt outlet & phone jack

Flooring: Hardwood
Optional: Ceramic

Bathroom Features

Countertop: Corian® lavatory top with integrated sink

Flooring: Hardwood
Optional: Ceramic

Medicine cabinet: Deluxe medicine cabinet

Shower: One-piece fiberglass shower with skylight

Toilet: Thetford® China, Macerator

Vent fan: Fantastic®

Bedroom Features

Sleeping: 74" x 60" RV Queen I.S. mattress, 74" x 48"
Flexsteel® EZ bed, (74" x 60" Hide-A-Bed with air
mattress optional)

Bedroom TV: 19"

Flooring: Deluxe sculpted carpet

Wardrobes: Hardwood

Bedsprad & Pillows: Designer

Night stands: Hardwood

Passenger seat: Lexington® ultraleather E pedestal

Power steering, Windows

Cab doors: Power door locks and window

Windshield wipers: Intermittant

Cab radio: AM/FM/CD radio

Cab mirrors: Chrome heated/ remote

ICC lights

Cruise control

Roof mounted dual air horns

Chassis battery disconnect

Manual air-dump switch

Full front cab sound insulation

CB radio: Optional

Trailer brake hand control valve

Overhead directional reading lights

Dash instrumentation: Speedometer, fuel
odometer, trip odometer, engine temp, oil
voltmeter, tachometer, air-pressure gauge

Rear sonar (Optional)

Tire air pressure monitor (Optional)

Construction Highlights

Floor: Heavy-duty 4" E-coated steel frame
rubber isolators

Walls: Sculptured, aerodynamic, fiberglass
sidewall panels

Aluminum framed: Square-tube aluminum
sidewall w/ all wall penetrations box
framed
Windows: Panoramic bonded, tinted

Roof: Square-tube aluminum-framed, one-
radiused fiberglass

Insulation

Floor: R-11 solid block foam
Sidewall & Ceiling: R-8 solid block foam

Cab: Steel safety cage surrounding transit
to coach

Front transition aerodynamic fiberglass

Molded fiberglass rear body cap

Slide outs: Living room - hydraulic/Bedroom
with side cross flow vent windows

Utilities

Heating - Furnace: 40,000 BTU Suburban
Single, digital thermostat for heating & c
Optional heating systems: Hydro-hot he
water

Electrical

Coach batteries: Three Group 31 AGM,
amp/hr. (Three 4D AGM, 630-amp/hr. o
Inverter: 1000 watt power

Optional: 2000 watt power (Forces 4E
optional)

Power cord: 50-amp

Generator (Standard): Onan® 5.5

Kitchen/Bath: Hardwood
Flooring option: Ceramic tile

Cabinets

Wood

Option 1: Natural Cherry

Option 2: Stained Cherry

Option 3: Natural Maple

Hinges: Deluxe, hidden cabinet hinges

Vent fan: Fantastic® fan w/ temp control and rain sensor

Driver Compartment

Backup camera: Color

Two side rear view cameras: Optional

GPS navigation system: Optional

Auxiliary 12-volt in-dash receptacle

Engine air conditioning

Driver seat: Lexington® ultraleather Bostrom - air pedestal

Optional: Powertech 8.0 or 12.0

Auto generator start: Optional (Forces inverter and larger batteries)

Coach battery disconnect switch by entrance

Cooling: Dual, low profile roof air conditioner BTU

Optional air conditioning: 15,000 BTU w/ insulated ceiling air ducts w/ controllable

Plumbing/Water

Water heater: Six-gal. Suburban® LP - 12-volt hi-capacity water pump

Heated water and holding tanks: Above fresh water hose & power reel: Optional



DYNAQUEST XL DQ320XL

Extraordinary styling and features abound with a color backup camera and monitor, a 23-inch flat screen TV and a Bose® LS 18 DVD/CD player with Surroundsound®. Four people can live and sleep comfortably thanks to the queen size bed in the rear, the optional Hide-A-Bed sofa and the room with a one-piece fiberglass shower with skylight.



The rear bedroom offers a large, comfy queen size bed and hardwood wardrobes and nightstands.



The contemporary cockpit with lots of leg room features cruise control, tilt and telescoping steering column, glass and overhead directional reading lamps.



The DynaQuest XL offers a surprisingly large amount of storage. An even bigger surprise is the extra storage available in the rear trunk.

